

# ASSEMBLY INSTRUCTIONS

## VANITY CABINET (VA3618D,VA3621D)

### CABINET PARTS LIST

A-Doors & Face Frame B-End Panels(2) D-Bottom Panel  
E-Back Panel H-Toe Kick G-Drawer Parts

### Drawer PARTS LIST

a-Front(2) b-Side(4) c-Bottom(2) d-Back(2) e-Drawer Slide(2 pr) f-Screw(Ø3\*30-16)

### HARDWARE PARTS LIST

1. Knob(4) 2. Screw(Ø3\*10-4)

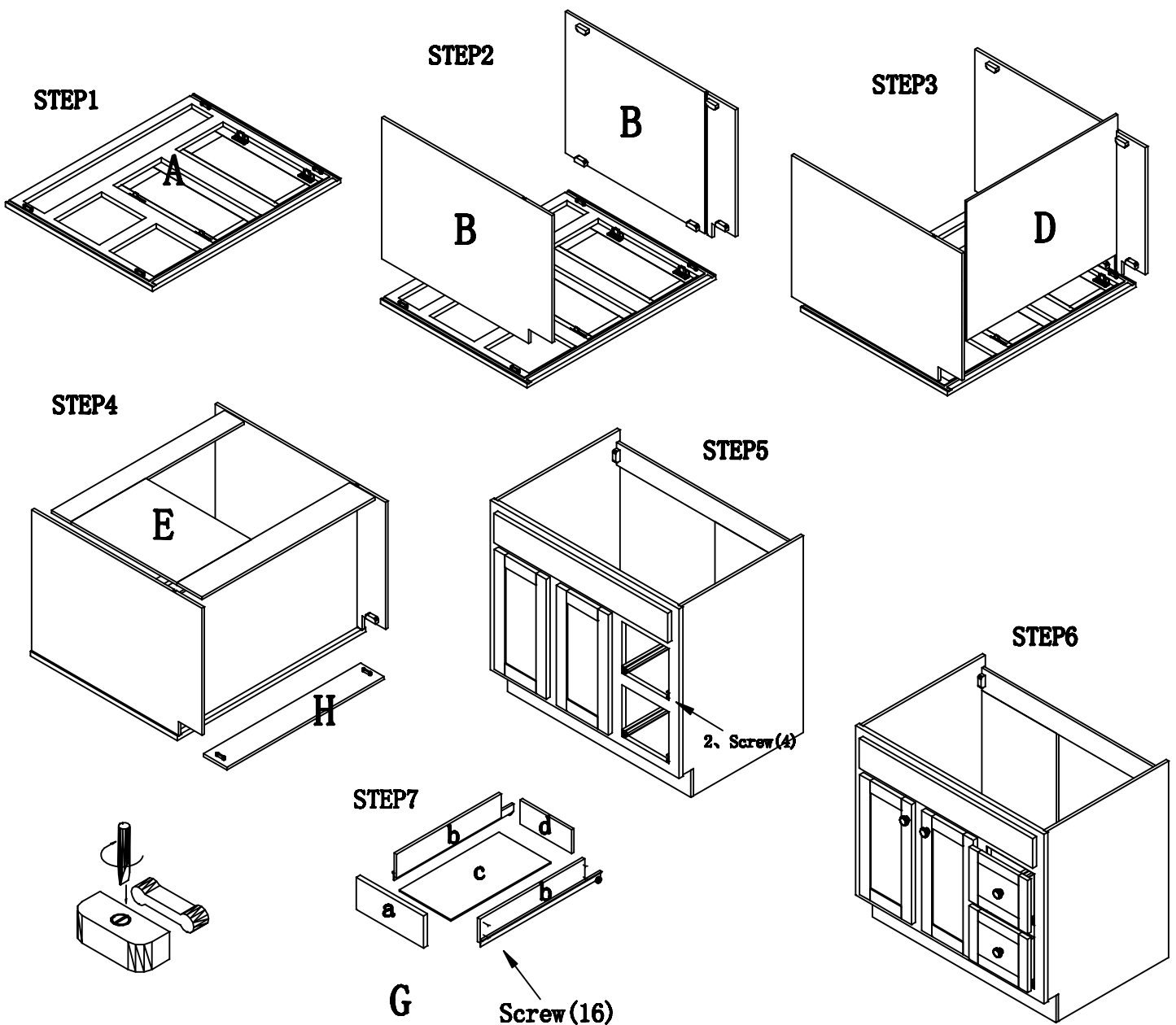

Your cabinet is complete. For installation, consult a professional contractor or building supplier for the proper installation method or materials to be used for your existing wall condition (e.g., wood, concrete, tile, etc.).